



Hines

Industrial & Logistics Europe

OnTime Logistics Park, Villaverde, Madrid

Logistics at Hines

With over 60 years' experience in the logistics and industrial sector throughout the world, Hines has a unique and long-term perspective on the sector and an understanding as to how it integrates into modern urban environments and supply chains.

Over this time, Hines has built an integrated global business which focuses on investment, acquisition, development and management of logistics and industrial properties. Our experience spans the development of more than 45 million square feet, the

acquisition of 38 million square feet and management of more than 50 million square feet globally. In every project, we aim to create best in class solutions for our customers. This can mean the best location, the greatest efficiency, or optimizing

property value. Hardworking and successful, these projects reflect the people and products they house, and the Hines team that is dedicated to them.



WORLDWIDE

Global Logistics Assets Under Management

EXPERIENCE
92.1 M sf
8.6 M sqm

ACQUISITIONS
38.2 M sf
3.5 M sqm

DEVELOPMENTS
45.4 M sf
4.2 M sqm

IN DESIGN OR UNDER CONSTRUCTION
8.6 M sf
800 K sqm

€4.3 B



IN EUROPE

Logistics Assets Under Management

EXPERIENCE
25.7 M sf
2.4 M sqm

ACQUISITIONS
22.6 M sf
2.1 M sqm

DEVELOPMENTS
3.1 M sf
0.3 M sqm

IN DESIGN OR UNDER CONSTRUCTION
2.4 M sf
0.2 M sqm

€1.3 B



Experience, Service, Innovation

Hines global real estate intelligence adds value to the development and management of logistics and industrial facilities.

In recognition of the ongoing convergence and impact of technology across all sectors, Hines takes a comprehensive approach to investments in logistics and industrial. Through our experience with development, acquisition and management in the office, retail, residential and land

sectors, Hines applies the same knowledge and skills of underwriting, acquisition, development, leasing, asset and property management and disposition as well as engineering management and sustainability solutions to logistics investments.



Development

Hines has **extensive global property development experience** and a **proven track record** in delivering logistics and industrial facilities that meet our tenants' needs, adding value at every stage of the development project.

Our industrial development services include:

- Build-to-suit developments
- Design-build projects
- Construction management
- Site selection and assessments
- General real estate consulting



Investment-grade developments, built to the latest standards with the highest environmental credentials

Sustainability and ESG

At Hines, ESG is not a single program or initiative. Instead it is the outcome of many different efforts across our organization. We understand the growing and urgent occupational needs of e-commerce businesses, whilst balancing their relationship with the local environment and communities.

Hines rigorously pursues the highest standards of service to our investors, clients and tenants through the expert design and efficient operation of our properties, the development of Hines staff and service to our communities. Our sustainable practices are critical to Hines' success.



Creating opportunities by leveraging existing tenant relationships



For over 60 years, Hines has led the way in global real estate, helping create many aspects of the modern urban environment – office, retail, residential, logistics. As logistics real estate becomes more and more integrated to other property sectors, we recognize a unique opportunity to leverage our expertise and established relationships to develop and invest in industry leading projects.



Representative portfolio



Royal Mail
Edinburgh, UK

20,043 sqm



ITPL
Wakefield, UK

19,241 sqm



DSG
Bristol, UK

25,106 sqm



Charles Tyrwhitt
Milton Keynes, UK

12,949 sqm



Cribbs Causeway
Bristol, UK

40,152 sqm



JLP Enfield
Greater London, UK

8,045 sqm



Raben Park Grodzisk Mazowiecki
Grodzisk Mazowiecki, PL

29,900 sqm



Raben Park Poznań
Poznań, Poland

41,300 sqm



Fresh Park Venlo
Venlo, NL

266,040 sqm



Łódź Urban Logistics
Łódź, Poland

36,500 sqm



Segro Logistics Park
Gdańsk, Poland

32,200 sqm



Distribution Park Okęcie
Warsaw, Poland

38,768 sqm



Siemens Berlin
Berlin, Germany

25,843 sqm



ITG Airport Munich
Munich, Germany

46,215 sqm



DHL Unna I
Unna, Germany

133,871 sqm



Distribution Park Annapol
Warsaw, Poland

7,138 sqm



Distribution Park Będzin
Katowice, Poland

54,545 sqm



Distribution Park Sosnowiec
Sosnowiec, PL

47,100 sqm



Cordes & Graefe, Unna III
Unna, Germany

17,845 sqm



Rhenus Bingen I
Bingen, Germany

44,036 sqm



Bingen II
Bingen, Germany

16,195 sqm



Distribution Park Żerań
Warsaw, Poland

44,500 sqm



DP Portfolio Garwolin
Warsaw, Poland

25,940 sqm



DP Portfolio Grodzisk Mazowiecki
Warsaw, Poland

16,030 sqm



Distribution Park Hamm
Hamm, Germany

68,500 sqm



Fiege Mega Center
Erfurt, Germany

88,500 sqm



Maintal Logistics
Frankfurt, Germany

35,877 sqm



DP Portfolio Mysłowice
Silesia, Poland

27,981 sqm



DP Portfolio Legnica
Wrocław, Poland

26,030 sqm



DP Portfolio Toruń
Toruń, Poland

30,308 sqm



Greiwing, CM & Dolphin
Duisburg, Germany

17,845 sqm



Villaverde
Madrid, Spain

17,474 sqm

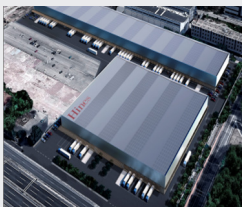

Airbus
Madrid, Spain

43,387 sqm

Our people

Our success lies in our ability to assemble the right team for each project we support. Logistics and industrial projects are critical pieces of infrastructure within the communities in which they are located. We are able to bring together people with the right experience to navigate not just the project itself, but also the intricacies of urban planning, together with a genuine understanding of how both goods and people move through urban environments.



Lars Huber
Chief Executive Officer
European Region



Alex Knapp
Chief Investment Officer
Europe



Lee Timmins
Chief Executive Officer
Eurasia Region
(Central Europe & Russia)



Logan Smith
Head of Logistics
Europe

European Logistics Research



Farhad Miah
Director - Research Europe

France



Xavier Musseau
Country head



Matthieu Reffay
MD, Acquisitions



Laurent Taleb
Development



Agnès Isbérie
Associate Director

Greece



Paul Gomopoulos
Country head



Andreas Kapsalis
Development Mgmt.



Dimitrios Vyzantios
Finance Director



Vangelis Mantzavinatos
Asset Management

Italy



Mario Abbadessa
Country head



Cristiano Brambilla
SVP, Construction



Federico Soffietti
Director



Alberto Gridelli
Analyst

Netherlands



Andy Smith
Country head



Ronald Banus
Asset Management



Herwi Rijksdijk
Director



Ethan van Embden
Analyst

Spain



Vanessa Gelado
Country head



Louis J. de Antonio
Asset Management



Jose Carlos Torres
Acquisitions



Juan Navarro
Construction Manager

Germany



Alexander Moell
Country co-head



Christoph Reschke
Country co-head



Christian Meister
Managing Director



Christina Laumen
Director



Felix Johow
Analyst



Syvain Hellin
Analyst

Ireland



Brian Moran
Country head



Peter Lynn
Asset Management



Ian Lydon
Director



Lucas Ruiz
Associate

Nordics



James Robson
Country head



Louis Dartiguenave
Acquisitions Manager



Julie Helweg
Asset Manager



Marcus Hjort
Analyst



Madsen Johansen
Analyst

Poland & CEE



Wojciech Ruman
Country head



Przem Iznerowicz
Head of Logistics



Kamil Nurek
Asset Management



Marek Szymczyk
Senior Analyst



Mietek Godzisz
SMD, Czech Republic/CEE

United Kingdom



Ross Blair
Country head



Ian Brown
SMD, Finance



Greg Cooper
Director



Mickey Scott
Asset Manager



Damien Hilbourne
Development

Our firm



Hines Global Presence

Locations and Workforce



225
cities

576 assets in
our property and
asset management
portfolio

25
countries

Australia, Brazil, Canada, China,
Denmark, Finland, France,
Germany, Greece, Hong Kong, India,
Ireland, Italy, Japan, Luxembourg,
Mexico, Netherlands, Panama,
Poland, Russia, South Korea, Spain,
United Kingdom, United States

● Regional Headquarters

Total Assets Under Management

\$144 B

\$75.5 B
Investment
management
services



\$68.6 B
Third-party
property-level
services

Listed as USD

Developments Worldwide

CURRENTLY UNDERWAY

165
Projects

63 M sf

COMPLETED

907
Projects

265.7 M sf

Property and Asset Management

752
Properties in asset management portfolio

246.6 M
Square feet

World Headquarters

2800 Post Oak Blvd., Suite 4800
Houston, TX 77056-6118 USA
713 621 8000

European Headquarters

5 Welbeck Street
London W1G 9YQ, U.K.
44 20 7292 1900

Eurasian Headquarters

Gogolevsky Boulevard 11, 7th floor
Moscow 119019, Russia
7 495 785 05 00

Asia Pacific Headquarters

28/F, AIA Central, No. 1 Connaught Road
Central, Hong Kong
852 3651 6198

Hines Europe Leadership

Lars Huber

Senior Managing Director/CEO

London

44 20 7292 1900

Logan Smith

Head of Logistics & Industrial - Europe

Amsterdam

31 655 491 306
logan.smith@hines.com

Hines Eurasia Leadership

Lee Timmins

Senior Managing Director/CEO

(Central Europe & Russia)

Moscow

7 495 785 05 00

CZECH REPUBLIC/CEE

Mietek Godzisz

Warsaw/Prague

48 22 351 2400
Mietek.Godzisz@hines.com

GREECE

Paul Gomopoulos

Athens

30 210 364 7895
Paul.Gomopoulos@hines.com

LUXEMBOURG

Margaret Fitzgerald

Luxembourg

352 26 43 37 92
Margaret.Fitzgerald@hines.com

POLAND

Wojciech Rumian

Warsaw

48 22 351 2400
wojciech.rumian@hines.com

FRANCE

Xavier Musseau

Neuilly-sur-Seine

33 1 41 45 80 80
Xavier.Musseau@hines.com

IRELAND

Brian Moran

Dublin

353 1 799 9900
Brian.Moran@hines.com

NETHERLANDS

Andy Smith

Amsterdam

31 6 30 70 81 29
Andy.Smith@hines.com

SPAIN

Vanessa Gelado

Madrid

34 91 703 00 23
Vanessa.Gelado@hines.com

GERMANY

Alexander Möll/Christoph Reschke

Berlin

49 89 14 333 740
Alexander.Moell@hines.com
Christoph.Reschke@hines.com

ITALY

Mario Abbadessa

Milan

39 02 896 2921
Mario.Abbadessa@hines.com

NORDICS

James Robson

Copenhagen

44 20 7292 1957
James.Robson@hines.com

UNITED KINGDOM

Ross Blair

London

44 20 7292 1900
Ross.Blair@hines.com

DISCLAIMER

IMPORTANT - by receiving this document you agree to the following terms:

Confidential Information

The reproduction of this document, in whole or in part, is prohibited. You are not permitted to make this document or the information contained herein available to any third parties. This document is not to be used for any purpose other than the purpose for which it was provided to you. Except as otherwise provided in a written agreement between the recipient and Hines or its affiliates, if the recipient receives a request under any applicable public disclosure law to provide, copy or allow inspection of these materials or other information regarding or otherwise relating to Hines or any of its affiliates, the recipient agrees (at its own cost and expense) to (i) provide prompt notice of the request to Hines, (ii) assert all applicable exemptions available under law

and (iii) cooperate with Hines and its affiliates to seek to prevent disclosure or to obtain a protective order or other assurance that the information regarding or otherwise relating to Hines or any of its affiliates will be accorded confidential treatment.

Disclaimer

The statements in this document are based on information which we consider to be reliable. This document does not, however, purport to be comprehensive or free from error, omission or misstatement. We reserve the right to alter any opinion or evaluation expressed herein without notice. Statements presented concerning investment opportunities may not be applicable to particular investors. Liability for all statements and information contained in this document is, to the extent permissible by law, excluded.

Data as of 30 June 2020 unless otherwise noted.

Hines
HINES.COM