

GALLERIA
LEASING OPPORTUNITIES





INSPIRED BY

THE UNCOMMON



The Galleria is the upper Midwest's most uncommon shopping destination offering exclusive fashion, home, beauty and dining moments. Located south of downtown Minneapolis in Edina, Minnesota, we carry a collection of well-known international brands, including Louis Vuitton, Tory Burch, Tiffany & Co., David Yurman, kate spade new york and more, in addition to luxe local stores and unique dining options.

A CURATED *MIX*

／ 70 HIGH-END NATIONAL BRANDS
AND LUXE, LOCAL RETAILERS.

／ 6 SUCCESSFUL RESTAURANTS ON-SITE.

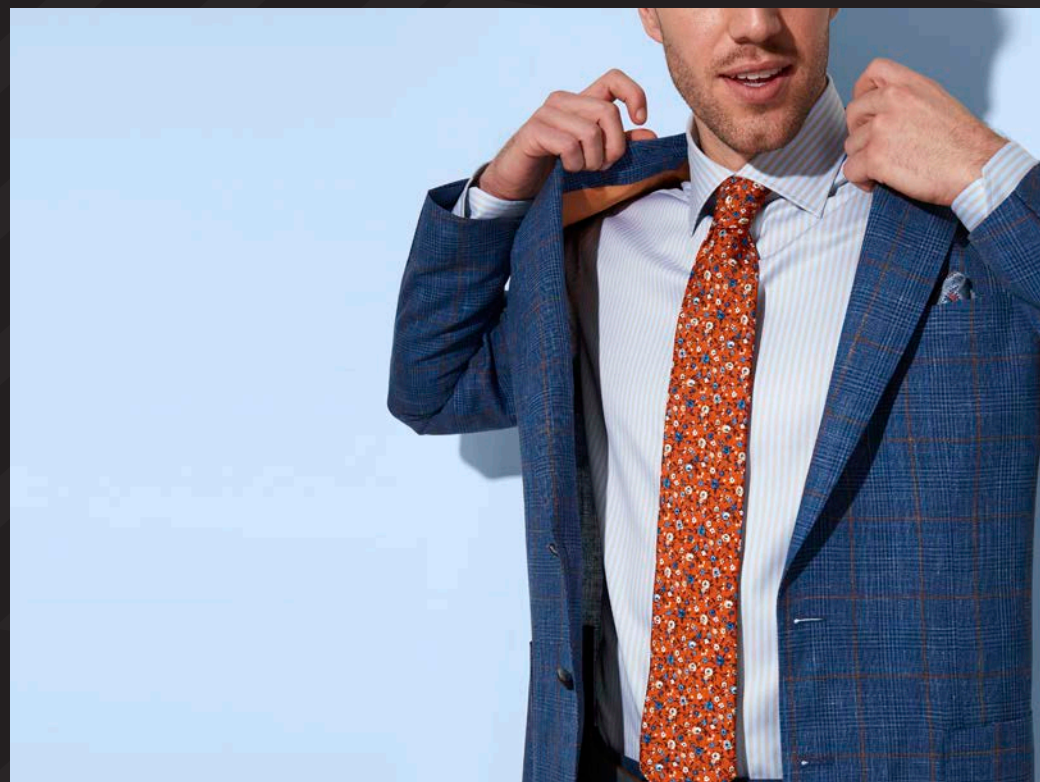



Galleria possesses the highest sales per square foot of any shopping destination in the Twin Cities market, as well as the upper Midwest.



THE LARGEST CONCENTRATION OF

LUXURY BRANDS

BETWEEN CHICAGO AND DENVER.



Top home stores draw from the FIVE STATE area, including Arhaus, Crate & Barrel, Design Within Reach, Interior Define, Parachute, Pottery Barn, PBteen, Pottery Barn Kids, Rejuvenation, Rypen and Williams-Sonoma.

FROM STEAK TO SUSHI, GALLERIA BOASTS

SIX DELICIOUS DINING OPTIONS

FOR WHATEVER YOU'RE CRAVING



Big Bowl

CôV Edina

CRAVE

Good Earth Restaurant

Sweetgreen

Pittsburgh Blue



BRANDS IN THE BUILDING

A snapshot of the unparalleled brands currently offered in our mix of sophisticated stores

3.1 Phillip Lim	Joie	Pedro Garcia
AG Adriano Goldschmied	Jo Malone	Peter Millar
Alexander Wang	Johnny Was	Piazza Sempione
Alexis Bittar	kate spade new york	Polo Ralph Lauren
Armani	KÜHL	Rebecca Minkoff
Badgley Mischka	La Mer	Robert Clergerie
Barbour	Lafayette 148	Robert Talbott
Bogner	Lilly Pulitzer	Robert Rodriguez
Carmen Marc Valvo	Longchamp	Scotch & Soda
Chan Luu	Louis Vuitton	See by Chloé
David Yurman	lululemon	Shinola
Diane Von Furstenberg	Max Mara Weekend	Shoshanna
Elie Tahari	Maison Scotch	Stuart Weitzman
Equipment	Milly	Suitsupply
Escada Sport	Missoni	Theory
Ferragamo	Moncler	Tiffany & Co.
Filson	Mulberry	Tom Ford
Frye	NIC+ZOE	Tory Burch
Hickey Freeman	Pajar	Vince
Hunter	Parachute	Vintage Chanel
James Perse	Parajumpers	Warby Parker





UNRIVALED *EXPERIENCES*



Galleria hosts an exceptional mix of events and traffic-driving initiatives throughout the year.

Fashion shows, seasonal promotions and curated experiences position Galleria as a fashion & trend leader in the market.

The can't-miss spring Floral Experience is an annual tradition that results in substantial traffic and sales increases for Galleria retailers.



15TH LARGEST

METROPOLITAN AREA IN THE U.S.

Total market annual retail sales in the Twin Cities exceed \$5.6 billion. Larger than those of San Diego, Denver, Austin, St. Louis, Tampa and San Jose.

18 Fortune 500 Companies - Minnesota ranks third in Fortune 500 Companies per 1 million people.



A DESIRABLE *DESTINATION*

One of the world's great cultural, business, sports and retail capitals, the Twin Cities offers a unique opportunity for the finest brands.



THE TWIN CITIES *MARKET*

Upper Midwest's cultural hub for music, comedy, art museums and theatre. Second only to New York City in theater seats per capita.



BUSINESS INSIDER RANKED MINNEAPOLIS ST. PAUL AMONG THE TOP 10 MARKETS FOR EDUCATED MILLENNIALS



3.6 MILLION RESIDENTS – LARGER THAN DENVER, CHARLOTTE, ST. LOUIS AND SAN DIEGO.



One of few U.S. states with a professional team in every major sport, including the Minnesota Vikings, Minnesota Twins, Minnesota Timberwolves, Minnesota Lynx, Minnesota Wild and Minnesota United FC.

AN IDEAL LOCATION

130,000+ cars drive by Galleria daily.

Galleria is surrounded by the area's
highest net-worth zip codes.

**FRANCE AVENUE HAS BEEN THE #1 RETAIL
DESTINATION FOR OVER 50 YEARS.**

Adjacent to The Westin Edina Galleria Hotel,
which has the highest ADR in the market.





TRADE *AREAS*



The primary trade area of 328,000 people boasts an average household income of \$109,400 with 2 in 3 people having college degrees. The audience nearly doubles with the addition of the daytime population of 308,747 employees, a rare concentration.

The total trade area of more than 1 million people has an average household income of \$93,400.
...and the population continues to rise.





THE GALLERIA *SHOPPER*

\$150

Average expenditure per trip. 40% above national benchmark.



**GALLERIA SHOPPERS ARE AFFLUENT BRAND ENTHUSIASTS
WITH 70% OF SHOPPING CENTER SALES FROM \$100K+
HOUSEHOLDS.**

**GALLERIA IS LOCATED IN EDINA, MN, WHICH BOASTS THE
FIRST, SECOND AND FOURTH MOST AFFLUENT ZIP CODES IN
THE ENTIRE STATE.**



More than 3 in 4 shoppers have college degrees.

STORE DIRECTORY

87	Allen Edmonds	612-851-2285
70	Allure Intimate Apparel	952-920-1111
69	Ampersand	952-920-2118
102	Arhaus Furniture	952-920-0463
92	Bachman's Floral	952-922-8910
103	Barnes & Noble	952-920-2124
104	Barnes & Noble Café	952-929-4366
17	Big Bowl	952-928-7888
86	Bluemercury	952-922-1100
100	Chico's	952-253-0560
48	Coach	952-925-5225
30	Cole Haan	952-920-9377
96	CòV Edina	952-999-4011
53	Crate & Barrel	952-920-2300
36	CRAVE	952-697-6000
25	David Yurman	952-920-9331
105	Design Within Reach	952-920-0225
50	Eileen Fisher	952-929-0469
110	Elina's Tailoring and Design	612-396-7035
98	Face Foundrie	855-959-3223
33	Fawbush's	952-922-5717
91	Filson	612-338-5506
71	Free People	952-920-1041
GC	Galleria Concierge	952-925-4321
60	Good Earth	952-925-1001
72	Hammer Made	952-681-2534
46	H.O.B.O.	952-926-3034
49	Interior Define	872-802-4119
76	InVision Optical	952-920-5458
80	J. Jill	952-926-6533
74	J. McLaughlin	952-582-1526
64	Jaxen Grey	952-219-7289
83	Johnny Was	612-421-7174
27	kate spade new york	952-920-9950
37	Legacy Toys	952-955-6938
99B	Lili Salon Spa	952-224-3300
43	L'Occitane	952-926-0126
23	Louis Vuitton	952-920-8000
88	Lululemon	952-900-7298
54	Madewell	320-299-2375
26	Marmi	952-920-0350
81	Melly	952-929-9252
66	NIC + ZOE	508-907-6234
94	Parachute	612-445-3680

41	Peloton	952-260-4592
90	Pittsburgh Blue	952-567-2700
11	Pottery Barn	952-925-1610
16	Pottery Barn Kids	952-848-8705
19	PB Teen	952-929-1205
45	Pumpz	952-926-2252
10	Rejuvenation	952-285-6865
24	Rothy's	952-600-7371
63	Rypen	800-560-0554
78	Shinola	612-338-5493
101	Soft Surroundings	952-562-0990
97	Starbucks	952-924-0344
31	St. Croix	612-339-0128
107	Suitsupply	952-213-2599
77	Sundance	952-920-0533
47	sweetgreen	952-900-2800
61	Sweet Ivy	952-456-6598
20	Tiffany & Co.	952-922-0066
99A	Tonic Barber	952-224-0059
29	Tory Burch	952-929-0020
89	Trail Mark	952-929-1950
28	Tumi	952-920-0682
85	Twill	952-922-2711
55	Vineyard Vines	952-929-9831
68	Warby Parker	952-314-7981
200	Westin Edina Galleria, The	952-567-5000
40	Williams-Sonoma	952-285-1338

CONCIERGE

Our concierge area, located between Vineyard Vines and Pumpz, offers store and general information as well as stroller and wheelchair check out. Galleria also offers family restrooms and nursing lounges. Restrooms and family rooms are located on both sides of the shopping center.

- The east restrooms/family rooms are located by lululemon.
- The central restrooms are located on the lower level. Take the elevator by Pumpz to access.
- The west restrooms/family rooms are located by Pottery Barn Kids.

KEY

 ELEVATORS

 ENTRANCES

GC GALLERIA CONCIERGE

 POST BOX

 RESTROOMS/FAMILY ROOMS

 STAIRS

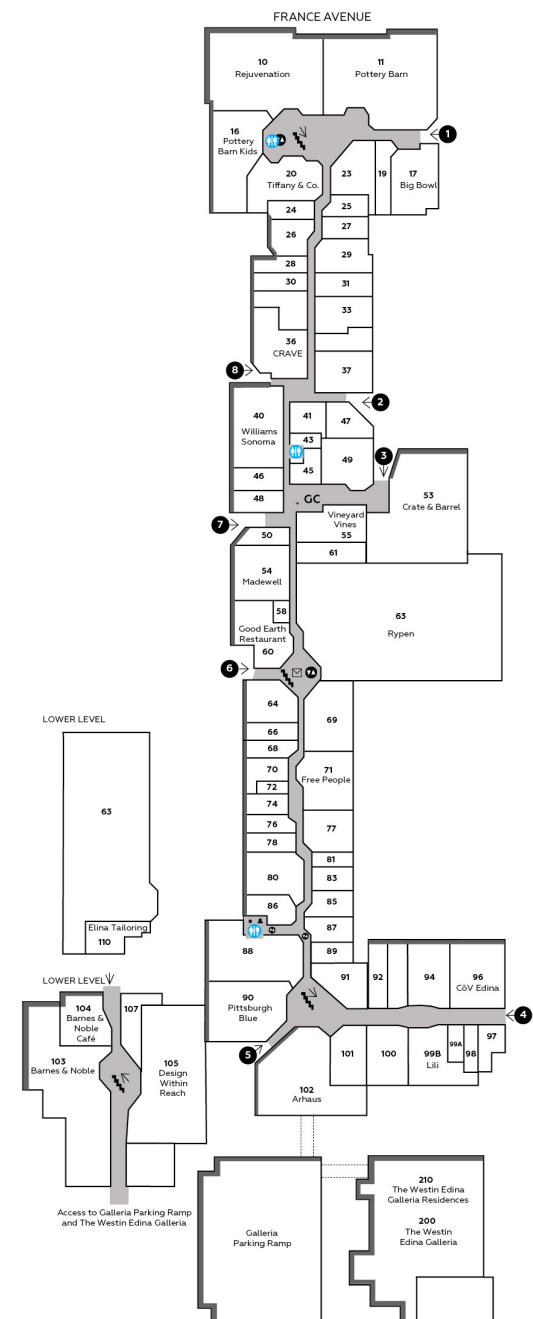

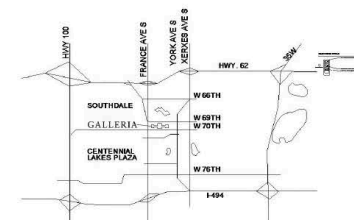
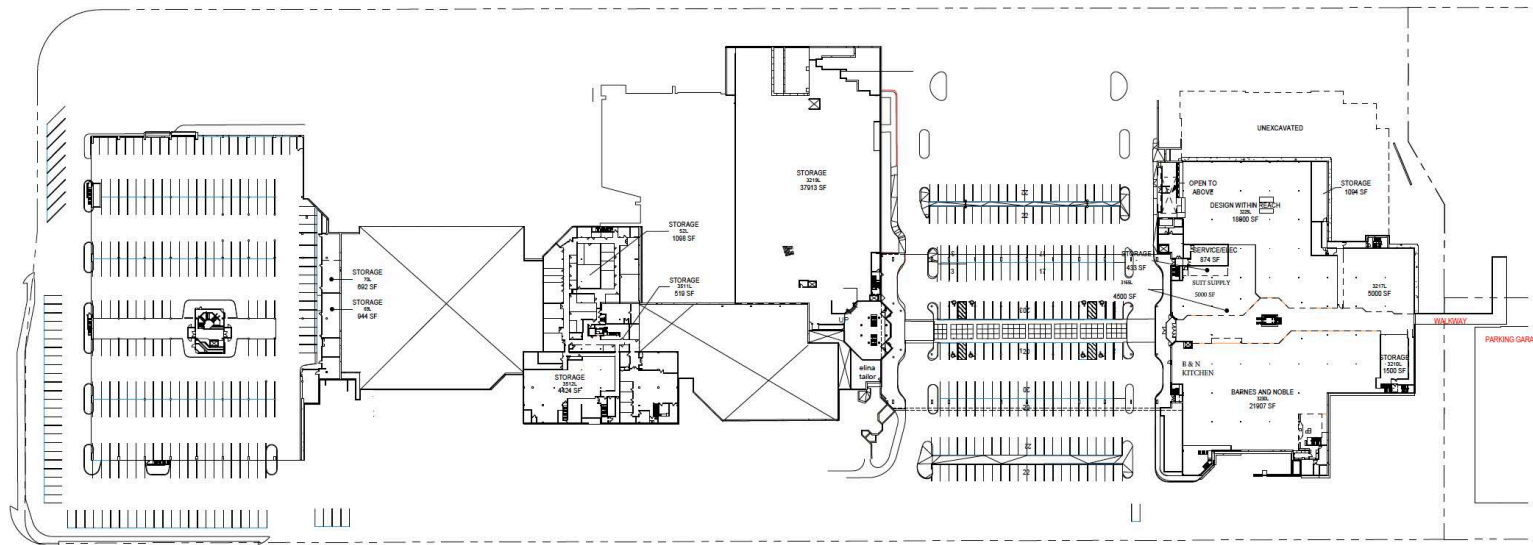
[illegible]

VICINITY MAP



GALLERIAEDINA.COM

@GALLERIAEDINA

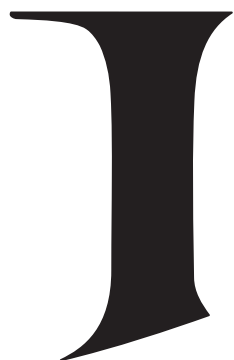

CONTACT



JENNIFER SMITH

JENNIFER.SMITH@HINES.COM

O:952.915.8489

C:612.916.4916

